

491 Conroe Park W. Dr. • Conroe, TX 77303

## Specifications: D 62-22 Diesel Pile Hammer

### Dimensions approx:

Length of Hammer:	A1	6173 mm	20' 3" ft/in
Hammer length w/starter guides:	A	6890 mm	22' 7" ft/in
Outer diameter of impact block:	B	710 mm	2' 4" ft/in
Min. Guiding Width:	C	813 mm	32" in
Width of hammer:	D	762 mm	30" in
Hammer Center to Pump Guard:	F	648 mm	2' 2" ft/in
Hammer Center to Trip:	G	533 mm	1' 9" ft/in
Hammer Depth:	H	1334 mm	4' 4.5" ft/in

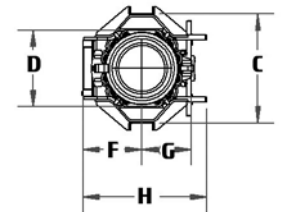
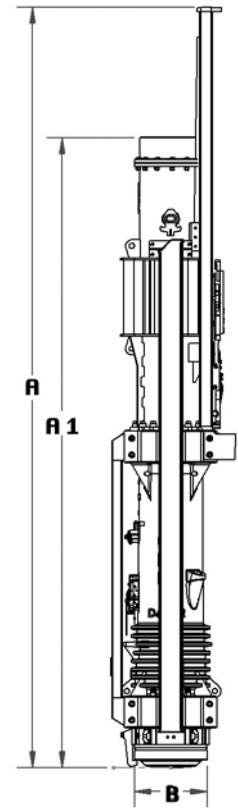

### VIEW PARTS MANUAL HERE

Pump Setting 1	107.3 kNm	78,919 ft. lbs.
Pump Setting 2	146.2 kNm	107,490 ft. lbs.
Pump Setting 3	182.5 kNm	134,160 ft. lbs.
Pump Setting 4	219.7 kNm	161,526 ft. lbs.

### Weights approx:

Weight of diesel pile hammer approx.:	15.83 <b>US tons</b>	31,650 lbs
Weight of piston approx.:	6200 kg	13,670 lbs
Impact Block approx.:	1100 kg	2,425 lbs
Tripping device approx.:	870 kg	1,918 lbs
Tool box approx.:	125 kg	275.6 lbs

### Energy per blow

Max:	219.7 kNm	161,526 ft lbf
Min:	107.3 kNm	78,919 ft lbf
Number of blows:		36–50 min

### Batter Info

Max. gradient of batter pile driven: 1:2 **or** with extension 1:1

### Consumption

Diesel fuel:	20 L hr.	5.28 gph
Lubrication oil:	2.0 L hr.	0.53 gph

### Volume

Diesel oil tank:	98 L	25.8 gal
Lube tank:	31 L	8.3 gal