

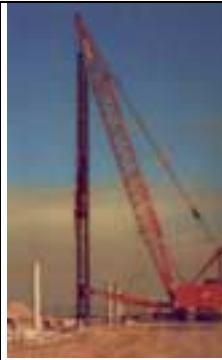

® PILECO, INC.

P.O. Box 16099, Houston, TX, 77222  
 phone: 713- 691 3000 toll free 1-800-231-0421  
 fax : 713-691 0089 e-mail : pileco@pileco.com

## U-Type Leads



### Free swinging lead systems :

- Useable with every crane of the right lifting capacity
- Same lead segments like fixed lead system except top and bottom section
- Free swinging leads can also supported with hydraulic spotters

### Fixed lead systems:

- attachable to most of cranes by using a boompoint-connector to the existing crane boom tip or a so called Hammer head attached to the crane boom

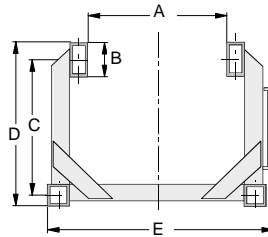
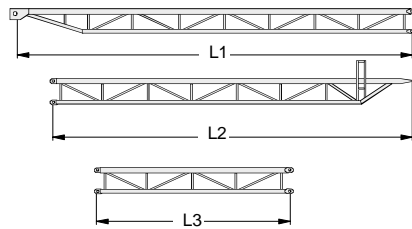

### Pileco lead systems with show following features:

- The Pileco U-26 and U-32 leads utilize our proven pin connectors for quick field assembly
- All lead sections are interchangeable in order to permit various length combinations

The leads can be furnished with side mounted auger tracks for installation of continuous flight auger drills

	U-21	U-26	U-32	U-42	U-48	U-54
A	21.5"	26.5"	32.5"	42.5"	48.5"	56.6"
B	8"	8"	8"	8"	8"	10"
C	28.75"	32.5"	32.5"	45.5"	45.5"	48"
D	34.75"	39"	39"	52"	52"	56"
E	39.5"	46.5"	52.5"	65"	71"	77"
L1 (Top Section)	40'	40'	40'	40'	40'	40'
L2 (Stab Section)	20'	20'	20'	40'	40'	40'
L3 (Intermediate)	20' , 40'	20' , 40'	20' , 40'	20' , 40'	20' , 40'	20' , 40'
Avg. Wt./Ft.	85 lbs	132 lbs	145 lbs	200 lbs	225 lbs	250 lbs

The standard lead sizes are : U-21, U-26, U-32, U42

Other lead sizes - We can shortly design and fabricate on your request .

Customized length of lead sections are made especially for fixed lead systems